

# Aquauno LOGICA



US  
002

ES  
015



8444

claber®

# US Table of contents

Introduction .....	3
Features .....	3
Operating controls .....	4
Operating tips .....	5
Battery installation .....	6
Installation on faucet .....	7
Programming .....	8
Frequently asked questions .....	9
Trouble shooting .....	10
Routine maintenance .....	11
Warranty .....	12
Declaration of conformity .....	13

We are pleased you have chosen the Aquauno Logica water timer, model 8444. This Italian-made timer utilizes the most sophisticated technology and most durable material bringing you years of low maintenance and a worry-free lawn. Read instruction manual carefully before programming; save manual for future use.

**If you have any questions regarding this water timer, please call our toll free customer service line at 800-930-4566 or email us at [info@claberinc.com](mailto:info@claberinc.com).**

## Features

The timer has 15 preset programs that are easily selectable with a straightforward dial control knob. With watering cycle ranging from 2 minutes up to 120 minutes, one of the 15 preset programs can be chosen to open from as little as 4 times a day to once a week. Timer operates on one 9V Alkaline battery (not included).

- Built-in stainless steel filter traps harmful contaminants.
- Program is NOT retained when battery is removed.
- Quick-click connect coupling for fast and easy hose removal.

# US Operating controls

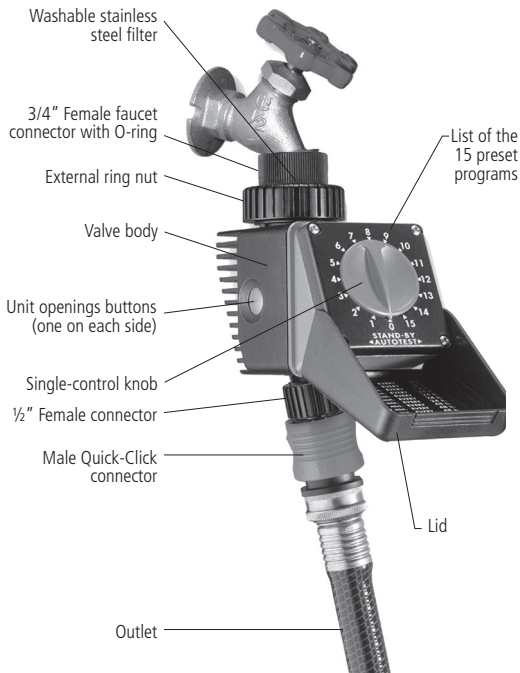

- The Logica does not allow to add or to modify the existing preset watering programs.
- Use Alkaline batteries only; do not use lithium or rechargeable batteries.
- Install new battery at the start of the watering season.
- Regularly wash the filter to prevent clogging.
- Remove from faucet when temperature reaches below 37.4°F (3°C), drain all water and remove batteries to avoid oxidization.
- When using for the first time, observe the progress of the program/s to ensure the unit operates properly.
- Be careful when pulling the hose or fittings to prevent damage to the unit.
- Do not use with operating pressure below 7.3 PSI (0.5 Bar) or higher than 145 PSI (10 Bar) and with water temperature exceeding 104°F (40°C).
- Do not install into any type of valve box or under the soil level.
- Do not submerge in water or other liquids.
- Use with tap water only.
- Keep the lid closed when not programming to protect against outdoor elements.



- Keep out of reach of children and animals.
- Do not expose at temperature below 37.4°F (3°C).

## US Battery installation

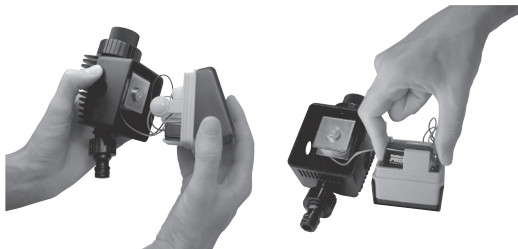

1. Press the two side buttons on the front panel then insert one new 9V Alkaline battery into the terminal.
2. Replace the battery back into the housing.

### Notes:

- Use only Alkaline batteries.
- Replace the battery at the beginning of the watering season.
- Setting is NOT retained when battery is removed.
- When timer is not in use for an extended period of time, remove the battery to avoid oxidation.



If battery dies during a watering cycle, unit will operate until the end of the program in progress. Once valve is closed, battery should be replaced.

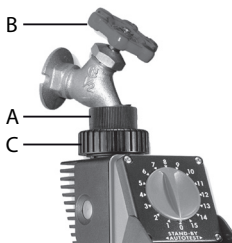

1. Loosen external ring nut C.
2. Tighten 3/4" female connector A on faucet B.
3. Tighten external ring nut C to timer housing.



- Do not install into any type of valve box or under the soil level.
- Use with tap water only.
- Do not use with operating pressure below 7.3 PSI (0.5 Bar) or higher than 145 PSI (10 Bar) and with water temperature exceeding 104°F (40°C).

# US Programming

Simply turn the single-control knob to one of the 15 preset watering programs and the timer will start the cycle within 10 seconds; therefore it is necessary to set the timer at the exact time you want it to start watering. When a program is chosen, there will be two clicks: the first click is for battery level check and the second click opens the valve to begin watering.

## Example:

In position 4, the timer releases water for 5 minutes twice a day.



## Notes:

- When the knob is turned to the 0 position, timer is (stand-by) inactive.
- The Logica water timer does not have a manual function mode; if you need to use your hose or faucet without disconnecting the unit, by simply turn the single-control knob to any program and allow 10 seconds of delay. Make note that this will reset your setting, so you will have to program the timer again at the desired time for the watering cycle to start.
- Give the unit 10 seconds to reset when changing programs.

## List of the 15 preset programs:

### PROGRAMS

1	1 min every	6 h.
2	5 min every	6 h.
3	2 min every	12 h.
4	5 min every	12 h.
5	10 min every	12 h.
6	5 min every	24 h.
7	15 min every	24 h.
8	30 min every	24 h.
9	60 min every	24 h.
10	90 min every	24 h.
11	30 min every	48 h.
12	60 min every	48 h.
13	60 min every	72 h.
14	90 min every	72 h.
15	120 min every	week



# Frequently asked questions

## Can I change any of the preset programs or add a new water cycle?

No, the Logica water timer is designed for fast and easy set-up.

## Can I use any 9V battery?

No, Alkaline only. Do not use lithium or rechargeable batteries.

## What happens if the unit is not removed during freezing temperature?

The ABS plastic components will crack causing the unit to be inoperable.

## How much water is delivered per minute?

Use chart below as a reference; chart is based on timer being tested at different PSI levels.

PSI							
5	10	15	30	40	50	60	80-145
↓	↓	↓	↓	↓	↓	↓	↓
1,7	3,2	4,3	5,9	6,9	7,6	8,3	9,2
Gallon/minute							

## US Trouble shooting

PROBLEM	SOLUTION
The unit is not working according to the selected program	Check that the water faucet is open.
	Since there is no low battery indicator, if program does not start within 10 seconds of when single-control knob is turned, change the battery.
	Verify that solenoid valve wires are inserted into correct outlets inside orange face plate.
	Choose another program to see if valve opens, then turn knob to 0 to see if it closes. <b>Note:</b> It is recommended to try multiple programs to verify that timer is working properly.
There is leaking from faucet connection	Clean stainless steel filter with water only.
	Check that the O-ring located in the 3/4" Female faucet connector is not missing.
	Filter must be in-line with water and the external ring nut tightened.

- Clean impurities inside and outside the unit.
- Check that all wires are in good condition.
- Take apart solenoid valve case and clean dirty areas with water only. When reassembling, make sure that valve wires are in a downward position (see fig. 1).

**Note:**

Depending on how hard/dirty water build-up is, the solenoid valve may need to be replaced.

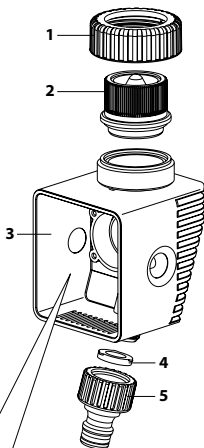
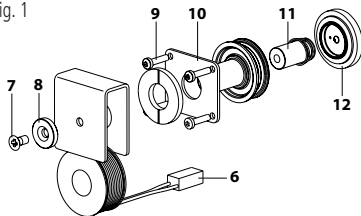

fig. 1



Product is warranted for a period of 2 years from date of purchase with proof of purchase receipt. Claber, at its own discretion, will repair or replace defective parts or unit if operated under normal working conditions.

Warranty will not be extended on product or parts resulting in operation misuse, alterations, neglect, abuse, improper installation or normal wear and tear.

Claber shall not be liable for damage on products manufactured by other companies when combined in use.

Claber, at its own discretion, may require product or parts to be returned to the Warranty Department. All shipping charges and risks are incurred by customer.

If coverage is found, product or parts will be repaired or replaced. Please allow 3-4 weeks to process return. All repairs or replacements are warranted only for the remainder of original warranty period, started at date of purchase.

Charges may incur if warranty coverage is not applicable.

To ensure warranty coverage, serial number (*i.e. 986 1383, located inside orange face plate identified by 6 or 7 digit code*) and a copy of sales receipt should be sent within 30 days after purchase in one of the following ways:

**1. MAIL**

Claber, Inc  
191 Stanley Street  
Elk Grove Village, IL 60007

**WRITE THE SERIAL NUMBER**

--	--	--	--	--	--	--

**2. FAX**

Fax: 847.364.4588

**3. EMAIL**

info@claberinc.com

Please note that if above information is not on file at time of contact, this may cause delay or refusal of warranty fulfillment. For any further information on customer assistance, you may contact Claber Inc. at toll free 1-800-930-4566.

**Claber S.p.A.**

Via Pontebbana, 22 - 33080 - Fiume Veneto - Pordenone - Italy

We hereby declare under our full responsibility that this product:

**8444 - Aquauno LOGICA**

conforms to European Directive 2004/108/CE

With reference to the technical standards defined under EN61000-6-1:2007 (immunity) and EN61000-6-3:2007 (emissions).

Fiume Veneto, 03/22/2010

CE 2010

Conformity Manager

Dott. Marzona Federico

