

# Aquauno PRATICO

US  
002

ES  
015



8493

claber®

# US Table of contents

Introduction .....	3
Features .....	3
Operating tips .....	4
Operating controls .....	5
Battery installation .....	6
Installation on faucet .....	7
Face panel .....	8
Programming .....	8-9
Setting the watering cycle .....	8
Checking watering cycle duration .....	9
Frequently asked questions .....	10
Trouble shooting .....	11
Routine maintenance .....	12
Warranty .....	13
Declaration of conformity .....	14

We are pleased you have chosen the Aquauno Pratico water timer, model 8493. This Italian-made timer utilizes the most sophisticated technology and most durable material bringing you years of low maintenance and a worry-free lawn. Read instruction manual carefully before programming; save manual for future use.

**If you have any questions regarding this water timer, please call our toll free customer service at 800-930-4566 or email us at [info@claberinc.com](mailto:info@claberinc.com).**

## Features

The timer is simply programmable with two buttons that allow one program per day from 1 minute to a maximum of 59 minutes. Timer operates on one 9V Alkaline battery (not included).

- Built-in stainless steel filter traps harmful contaminants.
- Program is NOT retained when battery is removed.
- Quick-click connect coupling for fast and easy hose removal.

# US Operating controls

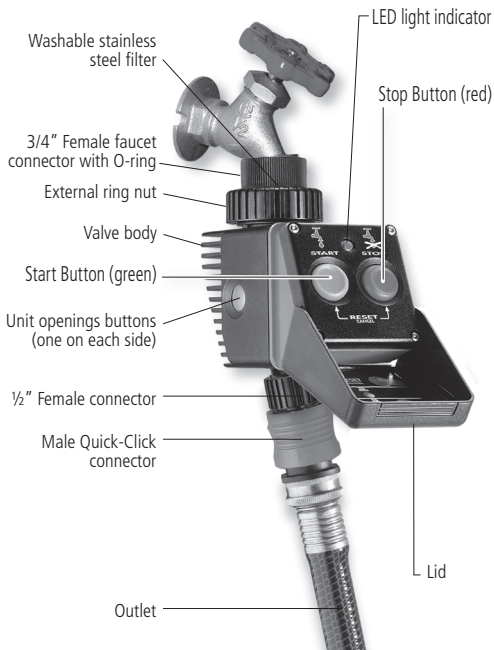

- Cycle repeats at the same time every day.
- Use Alkaline batteries only; do not use lithium or rechargeable batteries.
- Install new battery at the start of the watering season.
- Regularly wash the filter to prevent clogging.
- Remove from faucet when temperature reaches below 37.4°F (3°C), drain all water and remove batteries to avoid oxidization.
- When using for the first time, observe the progress of the program/s to ensure the unit operates properly.
- Be careful when pulling the hose or fittings to prevent damage to the unit.
- Do not use with operating pressure below 7.3 PSI (0.5 Bar) or higher than 145 PSI (10 Bar) and with water temperature exceeding 104°F (40°C).
- Do not install into any type of valve box or under the soil level.
- Do not submerge in water or other liquids.
- Use with tap water only.
- Keep the lid closed when not programming to protect against outdoor elements.



- Keep out of reach of children and animals.
- Do not expose at temperature below 37.4°F (3°C).

## US Battery installation

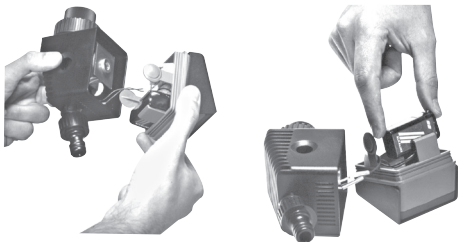

1. Press the two side buttons on the front panel then insert one 9V Alkaline battery into the terminal.
2. Replace the battery back into the housing.

### Notes:

- Use only Alkaline batteries.
- Replace the battery at the beginning of the watering season.
- If LED light indicator is at low visibility and steady, battery requires to be changed.
- No LED light indicator when battery is drained, missing from housing, or timer is in off-mode.
- Setting is NOT retained when battery is removed.
- When timer is not in use for an extended period of time, remove the battery to avoid oxidation.



If battery dies during a watering cycle, unit will operate until the end of the program in progress. Once valve is closed, battery should be replaced.

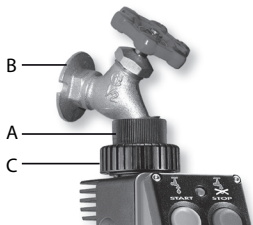

1. Loosen external ring nut C.
2. Tighten 3/4" female connector A on faucet B.
3. Tighten external ring nut C to timer housing.



- Do not install into any type of valve box or under the soil level.
- Use with tap water only.
- Do not use with operating pressure below 7.3 PSI (0.5 Bar) or higher than 145 PSI (10 Bar) and with water temperature exceeding 104°F (40°C).

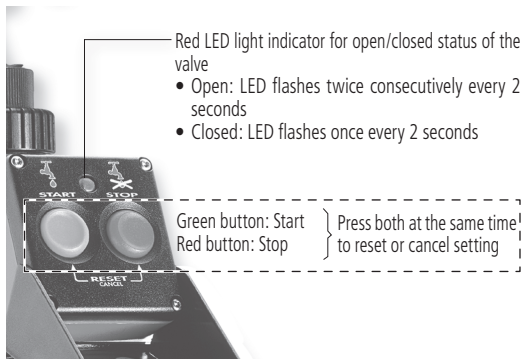

Red LED light indicator for open/closed status of the valve

- Open: LED flashes twice consecutively every 2 seconds
- Closed: LED flashes once every 2 seconds

Green button: Start

Red button: Stop

Press both at the same time  
to reset or cancel setting

## Programming

### SETTING THE WATERING CYCLE

#### Real time programming:

1. Press green and red buttons at the same time to clear out the timer.
2. Press green button at the time you want the watering cycle to start.
3. Press red button at the time you want the watering cycle to stop.  
If red button is not pressed within 60 minutes, the timer automatically programs a 5 minute watering cycle from the time that green button has been pressed.
4. The Timer has now stored time and duration of the watering program; the watering cycle will be repeated every day, once a day, at the same time and for the desired duration programmed.



## Direct programming:

1. Press green and red buttons at the same time to clear out the timer.
2. Press green button at the time you want the watering cycle to start.
3. Within 1 minute press and hold red button.
4. After 5 seconds start counting the number of flashes on LED light; each flash equals to 1 minute of watering.
5. Release red button when duration of watering cycle is reached.
6. The Timer has now stored time and duration of the watering program; the watering cycle will be repeated every day, once a day, at the same time and for the desired duration programmed.

## CHECKING WATERING CYCLE DURATION

1. Press green button.
2. LED light illuminates, shuts off for 3 seconds then starts flashing. There will be two sets of flashing sequences with 3 seconds pause in between:
  - 1<sup>st</sup> sequence - ten minute blocks.  
Ex: 3 flashes = 30 minutes.
  - 3 seconds pause**
  - 2<sup>nd</sup> sequence - one minute units.  
(Zero is indicated by 3 consecutive quick flashes).  
Ex: 8 flashes = 8 minutes.Length of the watering cycle is 38 minutes.

## Notes:

- No LED light indicator: battery is drained, missing from housing, or timer is in off-mode.
- Off/Reset: press both red/green buttons at the same time; LED light remains off until timer is programmed again.

## US Frequently asked questions

### Can I set the timer to release water more than once a day?

No, the timer allows only one watering cycle per day.

### Can I use any 9V battery?

No, Alkaline only. Do not use lithium or rechargeable batteries.

### What happens if the unit is not removed during freezing temperature?

The ABS plastic components will crack causing the unit to be inoperable.

### How much water is delivered per minute?

Use chart below as a reference; chart is based on timer being tested at different PSI levels.

PSI							
5	10	15	30	40	50	60	80-145
↓	↓	↓	↓	↓	↓	↓	↓
1,7	3,2	4,3	5,9	6,9	7,6	8,3	9,2
Gallon/minute							

PROBLEM	SOLUTION
The unit is not working according to the program set	Check that the water faucet is open.
	Verify the battery by checking the intensity of the LED light indicator.
	Verify that solenoid valve wires are inserted into correct outlets inside orange face plate.
There is leaking from faucet connection	Clean stainless steel filter with water only.
	Check that the O-ring located in the 3/4" Female faucet connector is not missing.
	Filter must be in-line with water and the external ring nut tightened.

# US Routine maintenance

- Clean impurities inside and outside the unit.
- Check that all wires are in good condition.
- Take apart solenoid valve case and clean dirty areas with water only. When reassembling, make sure that valve wires are in a downward position (see fig. 1).

## Note:

Depending on how hard/dirty water build-up is, the solenoid valve may need to be replaced.

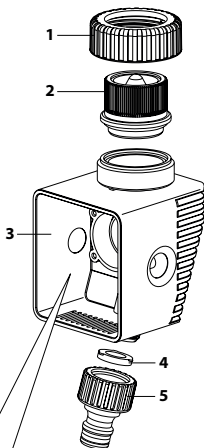
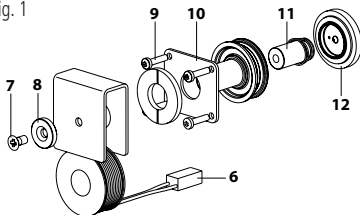

fig. 1



Product is warranted for a period of 2 years from date of purchase with proof of purchase receipt. Claber, at its own discretion, will repair or replace defective parts or unit if operated under normal working conditions.

Warranty will not be extended on product or parts resulting in operation misuse, alterations, neglect, abuse, improper installation or normal wear and tear.

Claber shall not be liable for damage on products manufactured by other companies when combined in use.

Claber, at its own discretion, may require product or parts to be returned to the Warranty Department. All shipping charges and risks are incurred by customer.

If coverage is found, product or parts will be repaired or replaced. Please allow 3-4 weeks to process return. All repairs or replacements are warranted only for the remainder of original warranty period, started at date of purchase.

Charges may incur if warranty coverage is not applicable.

To ensure warranty coverage, serial number (*i.e. 986 1383, located inside orange face plate identified by 6 or 7 digit code*) and a copy of sales receipt should be sent within 30 days after purchase in one of the following ways:

**1. MAIL**

Claber, Inc  
191 Stanley Street  
Elk Grove Village, IL 60007

**WRITE THE SERIAL NUMBER**

--	--	--	--	--	--	--

**2. FAX**

Fax: 847.364.4588

**3. EMAIL**

info@claberinc.com

Please note that if above information is not on file at time of contact, this may cause delay or refusal of warranty fulfillment. For any further information on customer assistance, you may contact Claber Inc. at toll free 1-800-930-4566.

# US C€ Declaration of conformity

**Claber S.p.A.**

Via Pontebbana, 22 - 33080 - Fiume Veneto - Pordenone - Italy

We hereby declare under our full responsibility that this product:

**8493 - Aquauno PRATICO**

conforms to European Directive 2004/108/CE

With reference to the technical standards defined under EN61000-6-1:2007 (immunity) and EN61000-6-3:2007 (emissions).

Fiume Veneto, 03/22/2010

C€ 2010

Conformity Manager

Ing. Pegolo Aladino