

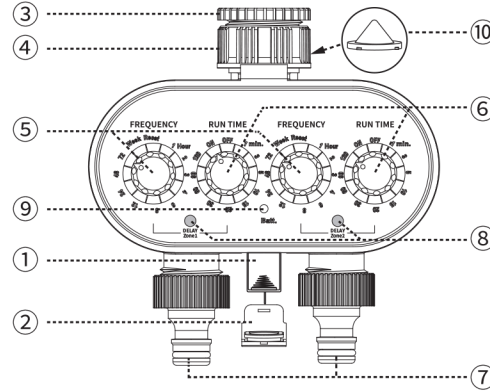

# INSTRUCTION

## TWO OUTLET TAP TIMER

### TIMER FEATURES



#### ① Battery compartment & ② Battery compartment cover

Slide out the battery compartment ①, and insert 2x (LR6/AA) 1.5V alkaline batteries.

#### ⚠ WARNING

- Use only fresh alkaline batteries at the beginning of the season. **DO NOT** use rechargeable batteries.
- Test the unit by turning the Run Time knob to ON position. You should hear the sound of the motor within 10 seconds. If you do not hear the sound, check if the batteries are installed correctly.
- Turn Run Time to OFF position before connecting to tap.

#### ③ 3/4" tap adaptor & ④ 1" tap connector

For 3/4" taps: install the timer onto the tap with the 3/4" adaptor ③ included.

For 1" taps: remove the 3/4" tap adaptor ③ and attach the 1" tap connector ④ to the tap directly. note: please always keep the filter ⑨ in place.

#### ⚠ WARNING

**DO NOT** use spanners or pliers to avoid damage to the timer.

#### ⑤ Frequency knob

Determine how often you will water, from 1 hour to 1 week.

#### ⑥ Run Time knob

Choose how long to water, from 1 minute to 120 minutes.

#### ⑦ Male snap-on connector

Connect hose attachment to the male snap-on connector ⑦ at the bottom of the timer.

#### ⑧ Delay button

To delay the start watering time, press Delay button for more than 3 secs until led is constantly ON, then each press of delay button means 1 hour delay of the next start watering time. **(EXAMPLE 3)**

#### ⑨ Led indicator

Led indicator flashes once every 4 seconds.

#### ⚠ WARNING

Replace with new batteries if led indicator flashes quickly or on steady.

#### ⑩ Filter

Filter traps dirt particles and prolong life of timer.

#### ⚠ WARNING

Clean filter regularly

#### ⑪ Top cover

Close cover to protect timer from dirt.

### PROGRAM TIMER

- 1. Set Frequency** (determine how often you will water, from 1 hour to 1 week.)
- 2. Set Run Time** (determine how long to water, from 1 minute to 120 minutes.)

**NOTE:** Make settings at the hour of the day you want watering to start. The first watering will start X hours later, X is the set Frequency hours.

**EXAMPLE 1:** To water 2 times a day for 15 minutes, set Frequency to 12 and Run Time to 15. First watering will start 12 hours after the knobs are set.

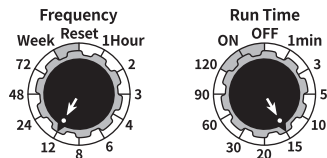

**EXAMPLE 2:** To water 1 time a day for 30 minutes, set Frequency to 24 and Run Time to 30. First watering will start 24 hours after the knobs are set.

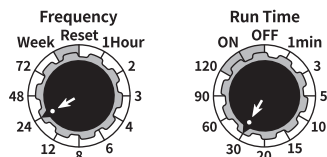

**EXAMPLE 1:** If you want the first watering to start at 7:00 am, then you make settings at 7:00 pm of the day (12 hours before).

**EXAMPLE 2:** If you want the first watering to start at 6:00 am, then you make settings at 6:00 am of the day (24 hours before).

#### ⚠ WHEN MAKING CHANGES AFTER INITIAL SETTINGS:

- Wait for min 3 seconds for timer to validate new settings after each change, which is indicated by quick flashing of the led indicator
- Changing Frequency or Run Time will change start time, which means the next watering time will be recalculated.

**EXAMPLE 3:** Now is 6:00 am, your setting is Frequency =4 and Run Time=15, which means to water for 15 minutes every 4 hours, so timer will start watering at 10:00 am.

Then at 8:00 am, you change the settings to Frequency =6 and Run Time=15, which means to water for 15 minutes every 6 hours, so the start watering time is changed into 2:00 pm.

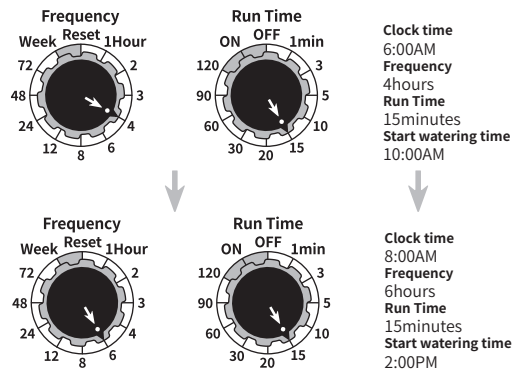

## MANUAL WATERING

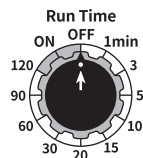

1. To start manual watering, set **Run Time to ON**
2. To stop manual watering, set **Run Time to OFF**
3. When done, set **Run Time** to other desired setting

## PROTECT TIMER FROM DAMAGE

1. This timer is only designed for outdoor use to control sprinklers or irrigation systems for watering, and can not be used for industrial purposes which in contact with food, chemicals and pesticides.
2. Operating water pressure is from **0 bar to 8 bars** (0 psi to 116 psi).

3. Use with clean and freshwater only whose temperature shall be above **1°C** and below **60°C**.
4. Protect timer during winter season or freezing conditions. Remove from tap and drain water inside, remove batteries and keep indoors.
5. Timer is water resistant, **NOT** water proof. The timer must be installed above ground and vertically to the tap. **DO NOT** submerge it in water.
6. **DO NOT** pull the hose while attached to the timer, to avoid damage to timer.
7. If timer doesnot work, please read through instruction to double check or contact your store service before returning to the store.

